

**OFFICE OF CHIEF ACADEMIC OFFICER**  
**Summary of State Board of Education Agenda Items**  
**Consent Agenda**  
**November 7, 2024**

**MISSISSIPPI SCHOOLS FOR THE DEAF AND THE BLIND**

- G. Approval to contract with Swift Recreation to construct a fully accessible and inclusive playground for students at the Mississippi Schools for the Deaf and the Blind (MSDB)

Background Information: MSDB applied for a grant through Blue Cross Blue Shield (BCBS) Foundation to fund an inclusive and accessible playground for our students. After meeting with the Executive Director of the BCBS Foundation and going through the preliminary process an RFP was issued for the playground needs for our school. After reviewing the RFP submissions, it was determined that Swift Recreation provided the best design, equipment, accessibility needs, and cost for this project. Upon approval from the SBE, the BCBS Foundation will submit to their Board of Directors for approval of the funding for this project. If approved by the Foundation, MSDB will receive the grant and oversee the construction process. The contract for the RFP is contingent upon funding through the BCBS Foundation.

Recommendation: Approval

Back-up material attached

# A Playground for All

A new **fully accessible and inclusive** playground for the Mississippi Schools for the Deaf and Blind



# The challenge

Create a colorful and inviting environment where ALL children can play and learn and grow TOGETHER here at Mississippi Schools for the Deaf and Blind.





# BCBS of Mississippi Foundation

## [BCBS of Mississippi Foundation](#)

- Since 2004, the BCBS Foundation has been helping our state by providing funding for grants for many different areas, including play spaces and ways to enhance health education.
- Their vision is to create a healthy Mississippi - this would include children of ALL abilities.

# A few of the play spaces funded by BCBS of Mississippi Foundation that inspired us



LeFleur's Bluff in Jackson, MS





# Mississippi Schools for the Deaf and Blind

## Important to know about our District:

- **We have two campuses** - both located on the same property.
  - [Mississippi School for the Deaf](#)
  - [Mississippi School for the Blind](#)
- **We serve children Pre-K through grade 12.**
- **We are a residential campus** - a good portion of our students live too far away from campus to be able to drive or ride a bus daily. Those students live on campus from Sunday through Friday each week. Those students utilize all areas of the campus, even outside regular schools hours, including play spaces. The students living on campus are as young as Kindergarten age.



# Mississippi Schools for the Deaf and Blind

Children at our campus, or who may come to our campus as a student in the future, have a wide range of needs and abilities when it comes to play spaces.

- Metal slides can cause cochlear implants to detach.
- Covered plastic slides interfere with cochlear implant receptors.
- Children with vestibular disorders (balance and inner ear) need play and exercise that helps to focus on that specific issue to aid in their overall health.
- Children with Albinism (which leads to their vision problems) have sun sensitivities.
- Children who are blind or visually impaired may require white canes in order to navigate their surroundings easier.
- Children who have vestibular disorders may require canes or walkers in order to navigate their surroundings easier.
- Children with walkers or wheelchairs need accessible play to be with their peers who do not have mobility issues.
- Deaf/Hard of Hearing children need road/bicycle safety specifically taught to address their needs in a safe environment.
- Blind/Visually impaired children need road/bicycle safety specifically taught to address their needs in a safe environment.



# Our current playground



Items to note:

- This was a typical day for one class out on the playground for recess.
- The class will push her chair so that the little girl in the wheelchair can play with them, but it is difficult.
- The only shading are the two little covered areas; at least one child in this class has Albinism.
- The slope in this area is almost 3 feet in difference from the right to the left.





## Current Issues

- Not accessible to children with mobility issues (wheelchairs, walkers, canes)
- Built over 20 years ago, parts are broken and need repair and some parts actually we may not be able to find in order to replace
- Does not address all of the needs of our students and future students (please see next slide for concerns)
- Has multiple safety concerns, including: being open to the parking area, no covering, and uneven ground is a tripping/falling hazard for some of our students and staff with limited/no vision and with mobility issues.

# Our needs:



- **FUNDING - this is where we hope to partner with BCBS Foundation of Mississippi**
- Grading - the ground is very uneven and not suitable for those with mobility issues
- Retaining wall - grading will require a retaining wall
- Building up on top of the ground - too many lines are underneath the area to dig
- Proper ground covering (poured in place rubber) for those with mobility needs (wheelchairs, walkers, and canes)
- Underground must plan for future camera and badge installation
- Covered for those with Albinism -sun sensitivities
- Very tactile for those who are Blind/VI
- High color contrast for those with VI
- Ramps for accessibility throughout
- No all metal slides for those with Cochlear Implants
- No covered plastic slides for those with Cochlear Implants
- Balance play for those with Vestibular issues
- Independent play (Activity panels)
- Areas for working on core strength
- Musical instruments
- Wheelchair accessible tables for outdoor health and bicycle/road safety class
- Area for free play with artificial grass
- Bicycle road to teach and practice bicycle and road safety - very important for our students
- Bicycles/tricycles with handles and safety gear to practice.
- A pool-style gate with one entrance close to a door for student safety



**Only portion truly accessible for those with mobility needs (wheelchair, walker, canes).**

Circled area is a ramp.





# Unusable portion of current playscape

Parts of walkway are broken or too weak to stand on.



# Current playground area



# Sitemap of the power/utility lines

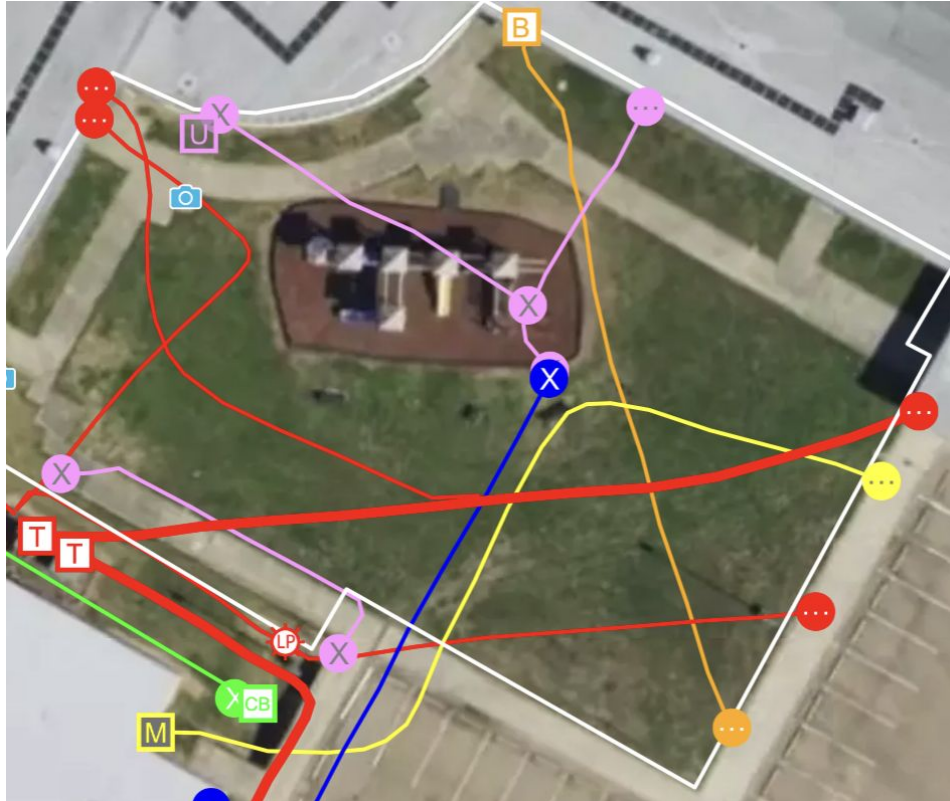





# Proposed Playground

- Almost triples the current play structure.
- Makes usable the grassy area so that children of all abilities can play there.
- Will meet the needs of our students now and in the future.
- NOT SHOWN IN THE DRAWINGS, BUT INCLUDED
  - In ground hopscotch play area
  - In ground four square play area
  - Wheelchair/walker accessible picnic table(s) for outdoor Health Class
- Addresses safety concerns.
- Meets quality standards for playgrounds and for those with disabilities.
- Overall design can be reduced to adjust for cost saving or to fit the needs of children.
- Can be completed and ready for children Fall 2025 school year.

General Notes:

Age Group

- 2-5 yrs  5-12 yrs  12-17 yrs  13+ yrs

- The Americans with Disabilities Act (ADA) may require that you make your park and/or playground accessible when viewed in its entirety. Please consult your legal counsel to determine if the ADA applies to you.
- For playground equipment to be considered accessible, accessible surfacing must be utilized in applicable areas.
- Although a particular playground design may not meet the proposed Access Board Regulations in regards to the appropriate number of ground level events, the actual playground may be in compliance when considering existing play components.
- All deck heights are measured from top of ground cover.
- If all abutting ground cover is required under and around all play equipment.
- The minimum recommended fall zone around the entire playstructure is shown. This zone is to be free of all tripping or collision hazards (i.e. roots, rocks, border material, etc.).
- All post heights are identified by text showing the post lengths, i.e. 36 represents a 36" inch post.
- Not all equipment may be appropriate for all children. Supervision is required.

AGE GROUP	5-12	ELEVATED PLAY ACTIVITIES - TOTAL	25
		ELEVATED PLAY ACTIVITIES ACCESSIBLE BY TRANSFER	17 REG ID 6
		ELEVATED PLAY ACTIVITIES ACCESSIBLE BY RAMM	9 REG ID 7
		GROUND LEVEL ACTIVITY TYPE	8 REG ID 8
		GROUND LEVEL QUANTITY	25 REG ID 9

Child Capacity: 199

4" WIDE PIP ROAD WITH TWO CROSSWALK LOCATIONS 30'5" LNFT OUTSIDE PERIMETER

EXISTING WALKWAY

CONCERTO TALL CHIMES 200203437  
 CONCERTO 3-CONGAS 200203443  
 CONCERTO SPIN CABARAS MEDIUM 200203440  
 CONCERTO VIBES 200203438  
 FS COMMUNICATION SIGN 200203488

ENTRANCE GATE

**PIP REQUIRED**  
 AREA: 6316 R<sup>2</sup>  
 PERIMETER: 401 R  
 The information provided is for estimation purposes only.

NEW 6" COATED CHAIN LINK FENCE AROUND PERIMETER 490' LNFT

BRICK RETAINING WALL THIS SIDE 150' LNFT

**TURF REQUIRED**  
 AREA: 7345 R<sup>2</sup>  
 PERIMETER: 128 R  
 The information provided is for estimation purposes only.

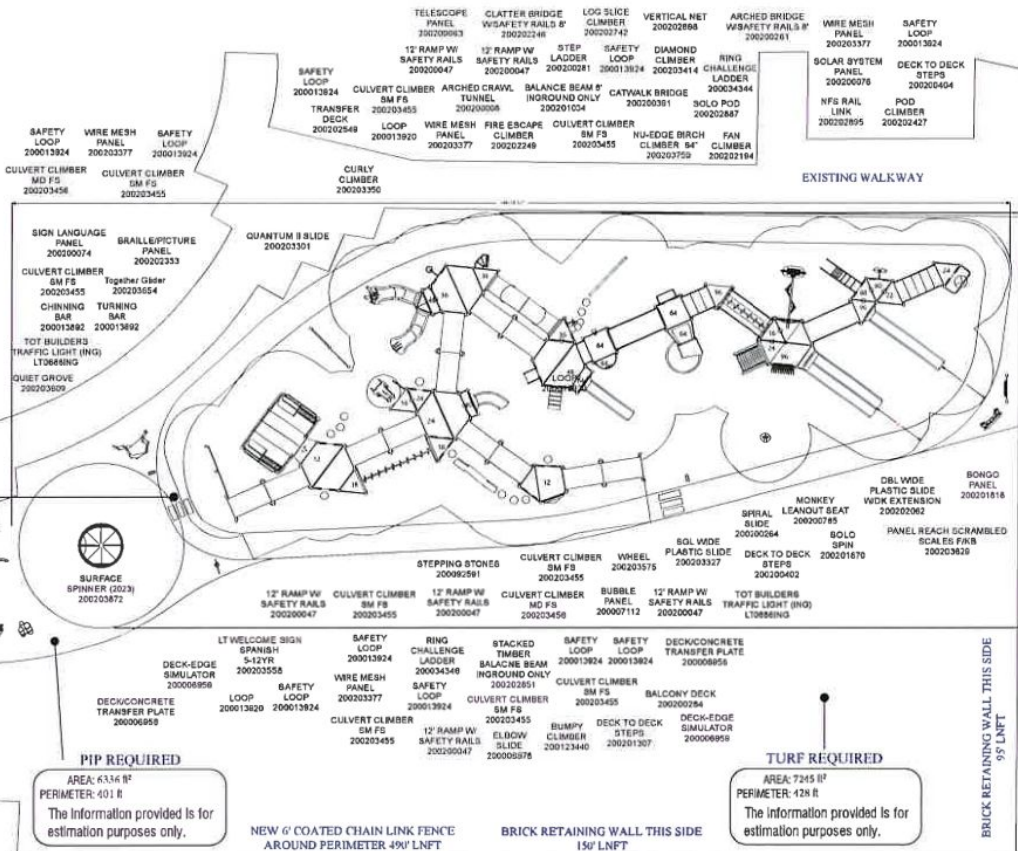

SINGLE FUNNIBEL 200202270  
 LADDER PANEL 200202428  
 HYPERSONIC SLIDE 200202195

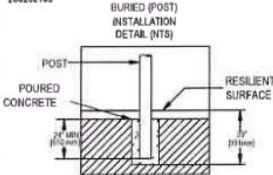

REFER TO INSTALLATION MANUAL FOR COMPLETE FOOTING DETAILS

Project:  
 MSDB  
 Jackson, MS  
 LTCPS rep:  
 Michele Dalon  
 Swift Recreation, LLC  
 (228) 870-5544

Ground Space: 155'-6" x 70'-6"  
 Protective Area: 148'-0" x 62'-6"

Drawn by: Rich McCarver  
 Date: 9/13/2024

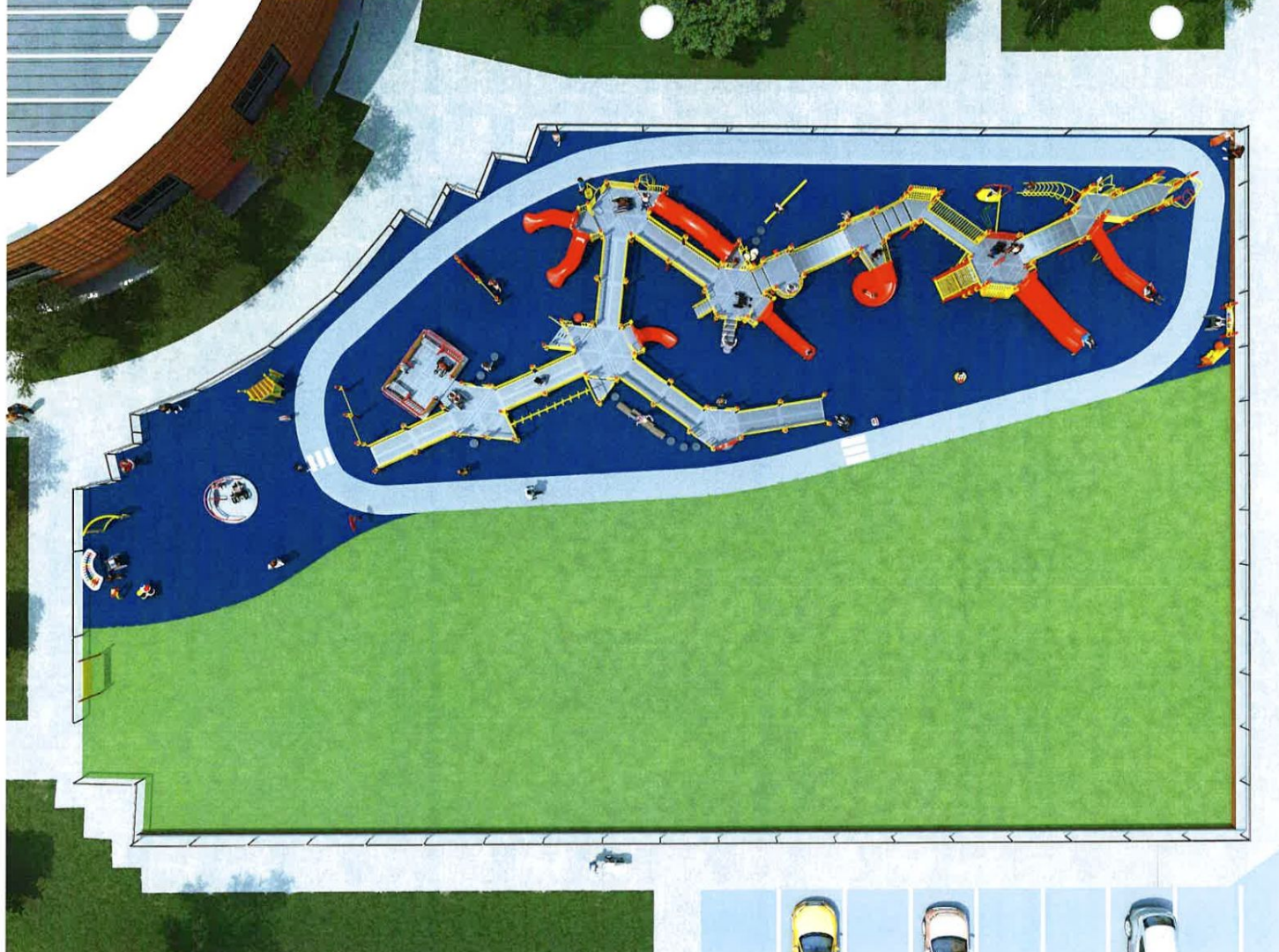

## Items to note:

- Overall design space well.
- Artificial grass gives easy access to pipes and lines underground if needed.
- Gate for entrance is near a building for safety and easy access, also in location to minimize disrupting the classrooms.
- Track will actually be a light tan instead of light gray (image later).





#### Items to note:

- High color contrast for those with visual limitations.
- Gate for safety surrounding the entire area.
- Plenty of play space for children of all abilities.
- Two traffic lights with crossing areas for O&M (Orientation and Mobility) practice and for road safety practice.





### Things to note:

- Lower right corner has an area that minimizes noise for those who get overstimulated.
- Two ramps that are accessible for those with mobility issues.
- Almost every part is accessible for those with mobility issues.
- Covered tunnel will be replaced with another item that is open.





Items to note:

- Wheelchair accessible merry-go-round.
- Stop light and crossing area for practicing Orientation and Mobility (there are actually 2).
- Items on the right may be replaced with different items for children to crawl on/around.





- Items to note:
- We decided to go with a tan/black track to lesson costs, but still keep the track with a high color contrast.

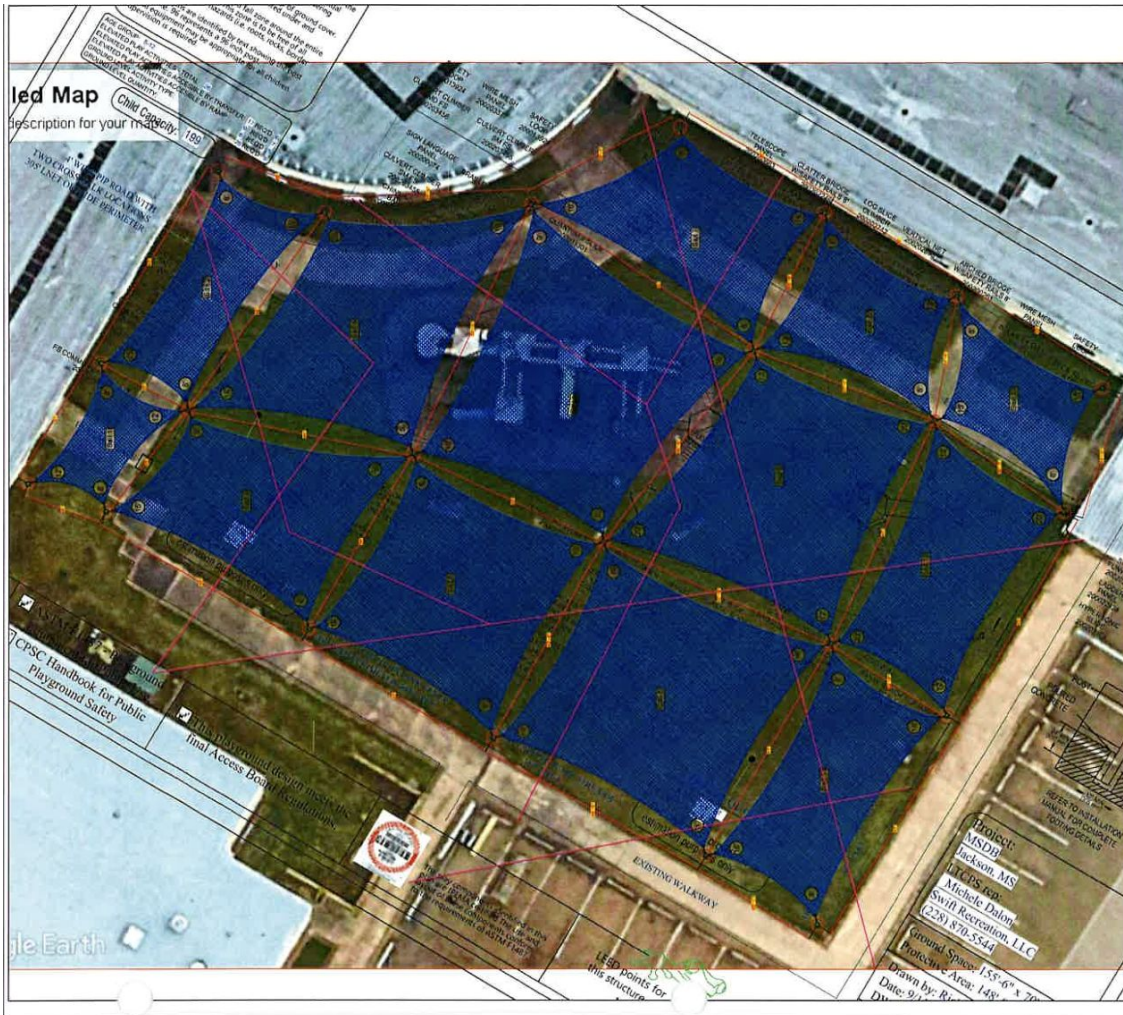

**\*\* PRELIMINARY - NOT FOR CONSTRUCTION \*\***  
**\*\* DIMENSIONS BASED ON GE/PDF OVERLAY \*\***

**IMPORTANT!**  
 This drawing is preliminary and is not for construction. It is intended for informational purposes only. It is not to be used for construction or other purposes. All dimensions are approximate and subject to change. All dimensions are in feet and inches unless otherwise noted.

**CONFIDENTIAL - PROPRIETARY INFORMATION:**  
 The information contained herein is proprietary to Modern Shade, LLC and is not to be used for any other purpose without the written consent of Modern Shade, LLC.

  <b>Modern Shade</b> 	  <b>MSBD</b> <b>Jackson, MS</b>
	  <b>A0</b>

- Items to note:
- Bird's eye view of the projected sails.
  - Shading will cover more than 85% of the entire area.
  - Shading is vital for our students with Albinism.
  - There are sails we could remove that are over walkways in order to lesson costs.



# Fee Proposal



September 25, 2024

**RE: Mississippi Schools for the Deaf and Blind "Request for Proposal: Playground Services"**

**Estimator:**

We propose to quote you on the following items for the above-mentioned project. Prices quoted are valid for delivery through the 4th quarter of 2024. If the order extends beyond that time, there will be a 2% price increase per quarter, including shipping.

**Removal/Disposal**

- o To remove and dispose of existing playground equipment and safety surfacing: \$8,160.00

**Shade Structures**

- o To deliver and install one Modern Shade custom joined sail cluster shade structure with 13 sails and 22 columns to cover 85% of the entire playground area. The base bid price includes our standard 95-340 shade fabric.
  - **Base bid materials delivered and installed:** \$342,658.00
  - **Add alternate for heavy 430 shade fabric upgrade:** +\$27,367.00

**Note:** Given the large span of some sails, exceeding 40 feet, we strongly recommend upgrading to the heavy 430 fabric to enhance the structure's durability and ensure safety.

**Playground Structure**

- o To deliver and install one custom Little Tikes Commercial inclusive playground structure, meeting all criteria listed in the bid documents, including custom Braille signage.
  - **Base bid materials delivered and installed:** \$426,477.00
  - **Add alternate for LTC Crickets upgrade:** +\$54,200.00

**Rubber Safety Surfacing**

- o To deliver and install 6,600 ft<sup>2</sup> of No Fault's poured-in-place rubber safety surfacing to meet playground equipment's critical fall height requirements, including hopsotch, four square inlays, and perimeter "road" track design with a 4" thick concrete sub-base under the playground equipment. The base bid includes a 50% black / 50% standard color blend.
  - **Base bid materials delivered and installed:** \$186,252.00
  - **Add alternate for 100% color blend upgrade:** +\$30,267.00



**Site Prep & Turf Safety Surfacing**

- o To perform the following site prep and surfacing work:
  - Bring in select fill dirt, compact, soil samples, and grade 13,560 ft<sup>2</sup> for the entire playground area.
  - Nailer board installation and 4" compacted limestone sub-base installation for the turf area.
  - 160 linear feet of 8" French drain DW corrugated slotted pipe, 40 linear feet of 8" DW solid pipe to the existing catch basin.
  - Brick retaining wall, 250 linear feet up to 3' tall, cinderblock with brick facade on one side, concrete capstone.
  - 7,815 ft<sup>2</sup> of Fusion Turf Zoysia EX turf safety surfacing, 1.5" pile height, with raw silica sand infill. Includes all seaming, trimming, infill application, and power broom finish.
  - 490 linear feet of 6' tall 8-gauge black vinyl chain link fencing with black posts, including one single swing gate with a 5' opening and one double swing gate with a 12' opening. Price does not include any core drilling or mounting fence to or inside the retaining wall.
  - **Base bid materials delivered and installed:** \$316,800.00
  - **Add alternate for four smaller areas to receive turf surfacing outside of the playground area:** +\$37,654.00

**Wheelchair Accessible Table**

- o To deliver and install one MyTCoat 8' expanded metal design table.
  - **Base bid materials delivered and installed:** \$318,000.00
  - **Add alternate for one extra picnic table:** +\$3,076.00

---

**Total Base Bid: \$1,283,532.00**  
**3% P&P Bond: \$38,505.96**  
**Grand Total: \$1,322,037.96**

We have seen 2 addenda.

PlayPower LT (Little Tikes) Farmington Inc. C/O Swift Recreation, LLC carries general liability, worker's compensation, auto, and umbrella insurance. If waivers of subrogation, OCP, builder's risk, or other insurances are required, an additional fee will be charged.



**Fee Proposal Notes:**

- o **Overhead and Profit:** Overhead on this proposal has been calculated at 8%, and profit has been calculated at 8%.
- o **Personnel Details:** The key personnel involved in this project, including Jeff Prangler, Christina Swift, Michele Dalon, Christine Cronin-Iddings, Shannon Columb, and Guy Harper, are salaried professionals and do not receive hourly wages. The installation crews, who are integral to the project's execution, are the personnel who receive hourly compensation. These hourly rates, along with their roles and responsibilities, will be provided based on the specific installation crew assigned to the project timeline. These details can be provided upon request to ensure they accurately reflect the personnel involved in the project.
- o **Flexibility in Personnel Assignment:** Our approach is to tailor the installation team to best meet the project's needs at the time of execution, considering factors such as crew availability and project timelines. As such, the precise details of the fee schedule, including personnel costs, are flexible and can be provided more specifically when the project schedule is finalized.
  - **Labor Rate Breakdown:**
    - General Laborers: \$17+/hr, depending on the task, skill level, and years of experience.
    - Supervisors: \$31.25+/hr, depending on the task, skill level, and years of experience.
- o **Justification and Transparency:** Rest assured, we prioritize transparency and can provide detailed rates upon request once installation begins.





## **Next steps for MSDB**

- Obtain School Board approval to continue this project, if funding is obtained.
- Obtain an offer for a Grant application from the BCBS of Mississippi Foundation.